

MINISTRY OF TRANSPORTATION AND
COMMUNICATIONS NOTICE

Subject: The adoption based on Article 14.1.3 and Article 4 of Annex VI "Regulations for Prevention of Air Pollution from Ships" under "International Convention for the Prevention of Pollution from Ships (MARPOL)": Foreign vessels and flag ships sailing in international routes shall utilize low sulfur fuel oil (sulfur-bearing not more than 0.5% by weight), or equipment or alternative fuels that achieve the equivalent effect of emission reduction when entering into international commercial port area under the jurisdiction of the Republic of China shall be adopted and take effect on 1st January, 2019.

Based on: Article 75 of the Commercial Port Law.

Announcement:

1. This case was the MEPC.280(70) resolution passed by the International Maritime Organization (IMO) Marine Environment Protection Committee (MEPC) at its 70th meeting in October 2016, to amend Article 14.1.3 of Annex VI "Regulations for Prevention of Air Pollution from Ships" under "International Convention for the Prevention of Pollution from Ships (MARPOL)". In order to protect the ecological and marine environment of the earth, starting from 1st January, 2019, foreign vessels and flag ships sailing in international routes shall utilize low sulfur fuel oil (sulfur-bearing not more than 0.5% by weight), or any appliances, devices, and alternative fuels that meet the requirements of the Convention standards and achieve the equivalent effect of emission reduction when entering into international commercial port area under the jurisdiction of the Republic of China (refer to the attachment).

The enclosed document is the main ship control requirements based on Article 14.1.3 and Article 4 of Annex VI "Regulations for Prevention of Air Pollution from Ships" under "International Convention for the Prevention of Pollution from Ships (MARPOL)".

我國國際商港區域(水域經緯度座標及港區界線)
 International commercial port area under the jurisdiction of the Republic
 of China (Taiwan) (Water latitude and longitude coordinates and port
 boundaries)

(一) 基隆國際商港(Port of Keelung)

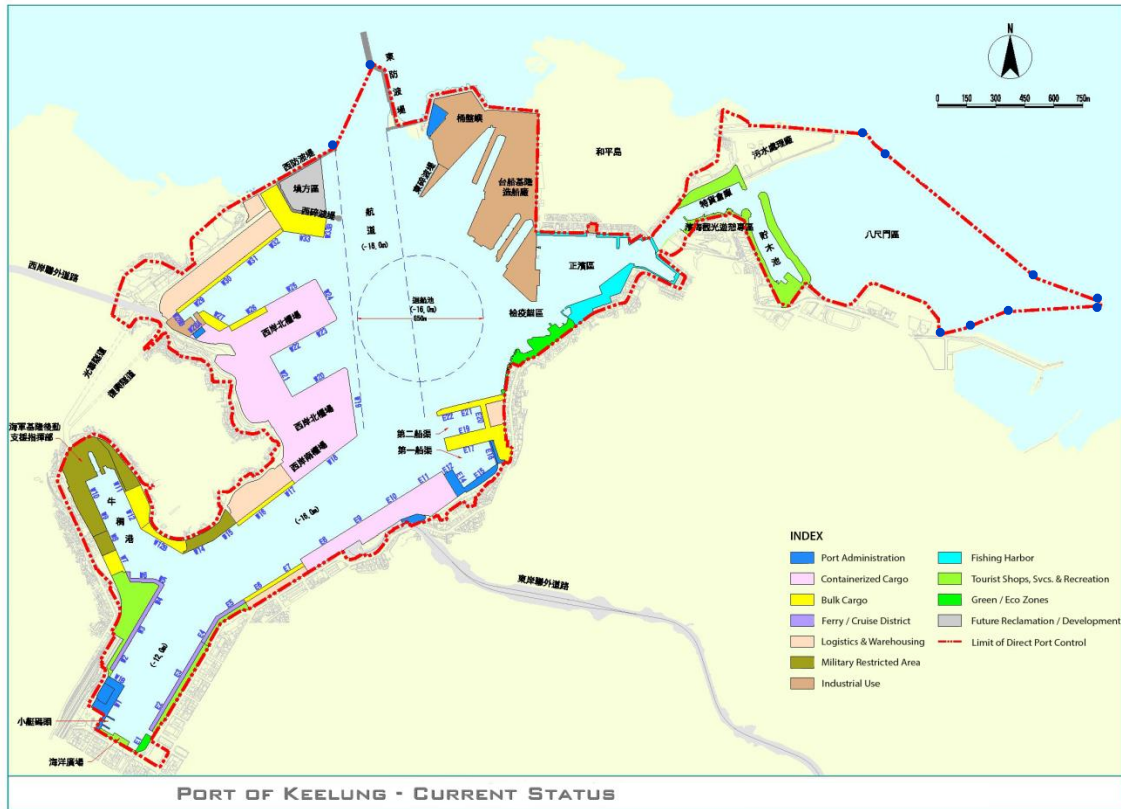

港區示意圖(Port area diagram)

水域經緯度座標及港區界線(WGS84經緯度座標系統)
 Water latitude and longitude coordinates and port boundaries-
 WGS84 latitude/longitude coordinate system

點位 Point	東經 E East Longitude	北緯 N North Latitude
A	121° 45' 16.4012"	25° 09' 44.5799"
B	121° 45' 09.3468"	25° 09' 30.7209"
C	121° 46' 47.4016"	25° 09' 32.3934"
D	121° 46' 48.6691"	25° 09' 30.7416"

E	121° 47' 18.6017"	25° 09' 08.0159"
F	121° 47' 30.3659"	25° 09' 04.0412"
G	121° 47' 30.2752"	25° 09' 03.3830"
H	121° 47' 12.6378"	25° 09' 02.4719"
I	121° 47' 05.0567"	25° 08' 59.6954"
J	121° 47' 00.3948"	25° 08' 58.7433"

(二) 臺中國際商港(Port of Taichung)

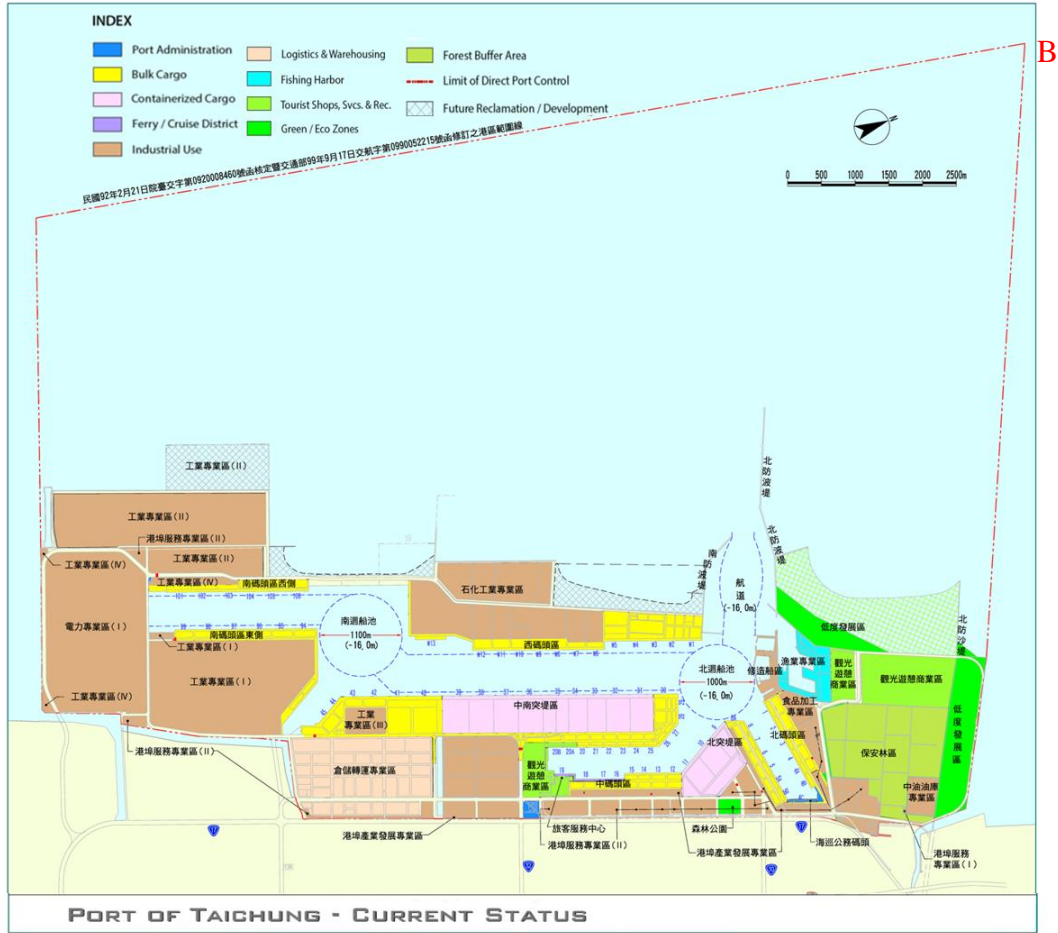

港區示意圖(Port area diagram)

水域經緯度座標及港區界線(WGS84經緯度座標系統)
Water latitude and longitude coordinates and port boundaries-
WGS84 latitude/longitude coordinate system

點位 Point	東經 E East Longitude	北緯 N North Latitude
A	120° 31' 39.5149"	24° 18' 48.6039"
B	120° 27' 17.1124"	24° 20' 42.6775"
C	120° 25' 40.0928"	24° 13' 36.5680"
D	120° 28' 05.5805"	24° 12' 45.4794"

(三) 高雄國際商港(Port of Kaohsiung)

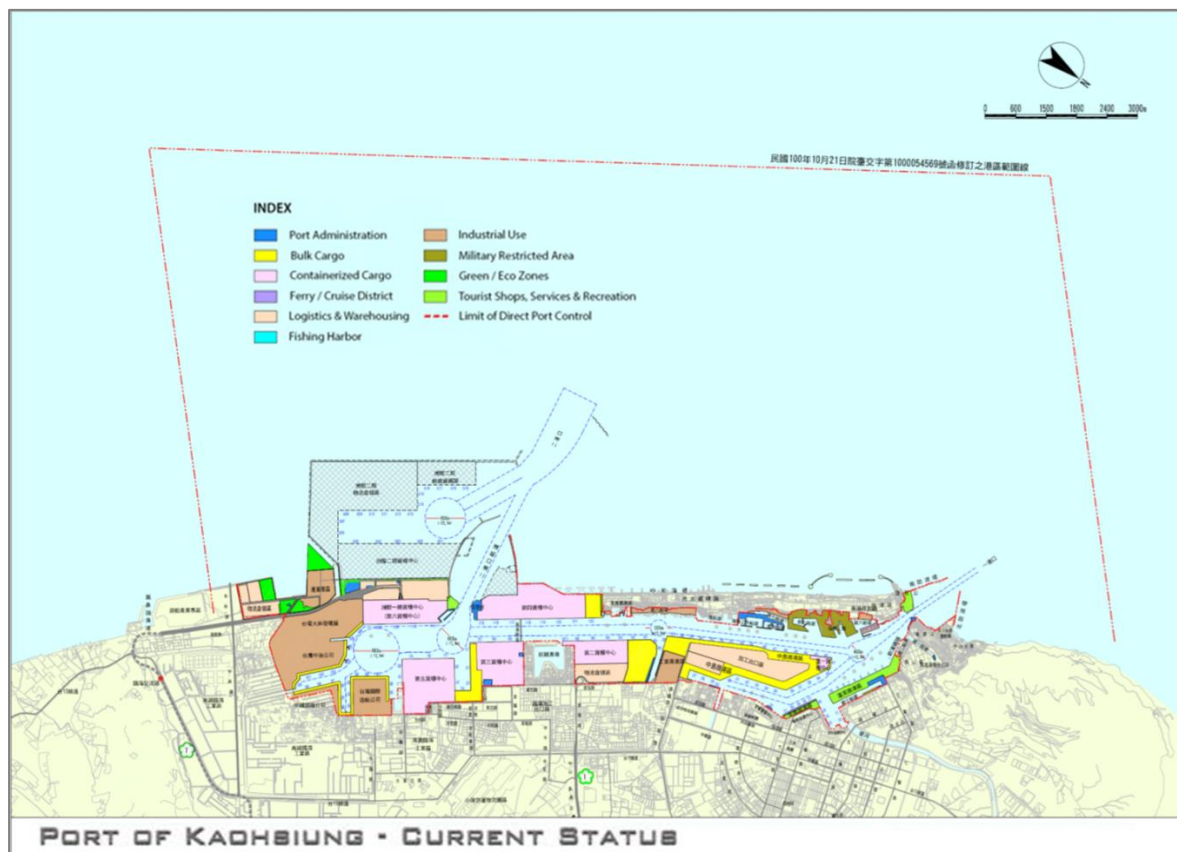

港區示意圖(Port area diagram)

水域經緯度座標及港區界線(WGS84經緯度座標系統)
 Water latitude and longitude coordinates and port boundaries-
 WGS84 latitude/longitude coordinate system

點位 Point	東經 E East Longitude	北緯 N North Latitude
A	120° 14' 46.9846"	22° 38' 53.6348"
B	120° 10' 57.4687"	22° 35' 18.3405"
C	120° 20' 48.9567"	22° 31' 03.6090"
D	120° 16' 59.5409"	22° 27' 28.4147"

(五) 臺北國際商港(Port of Taipei)

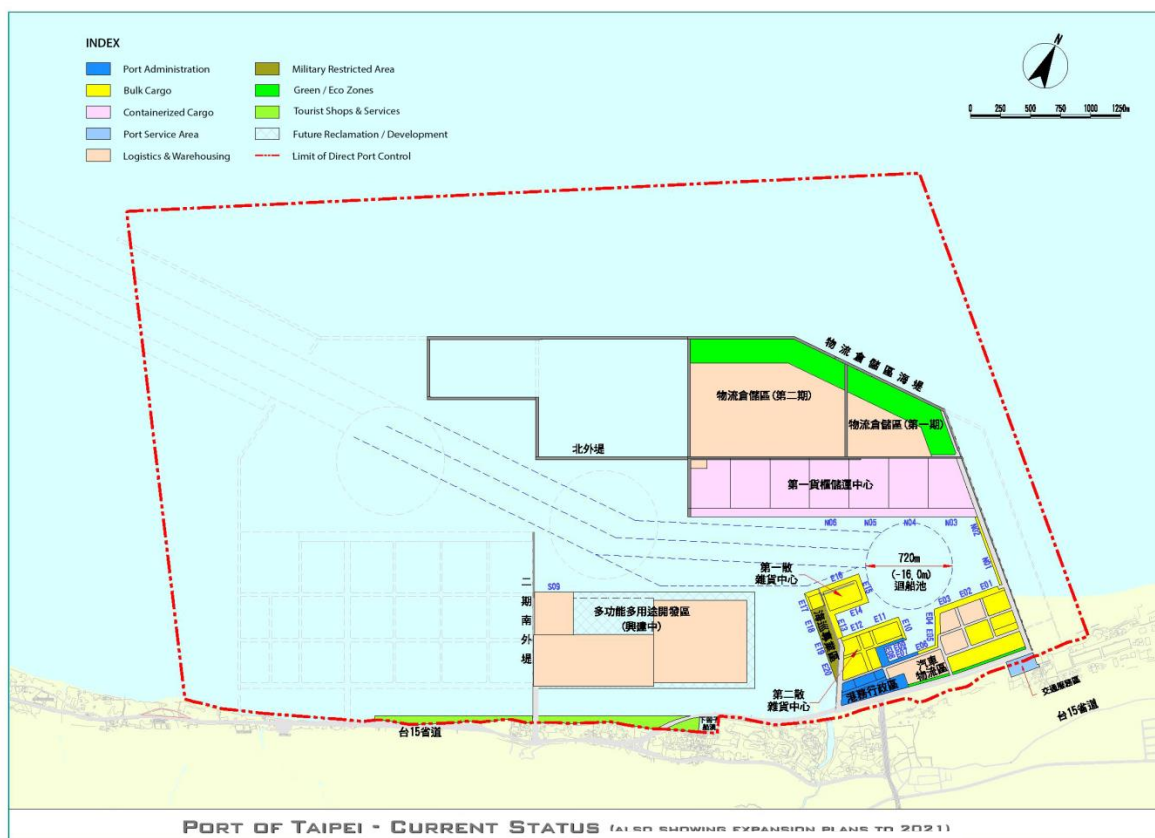

港區示意圖 (Port area diagram)

水域經緯度座標及港區界線(WGS84經緯度座標系統)
 Water latitude and longitude coordinates and port boundaries-
 WGS84 latitude/longitude coordinate system

點位 Point	東經 E East Longitude	北緯 N North Latitude
A	121° 24' 20.9109"	25° 09' 40.3558"
B	121° 22' 35.9774"	25° 11' 13.1027"
C	121° 19' 08.7590"	25° 09' 30.5511"
D	121° 20' 27.4610"	25° 07' 38.4951"

(六) 蘇澳國際商港(Port of Suao)

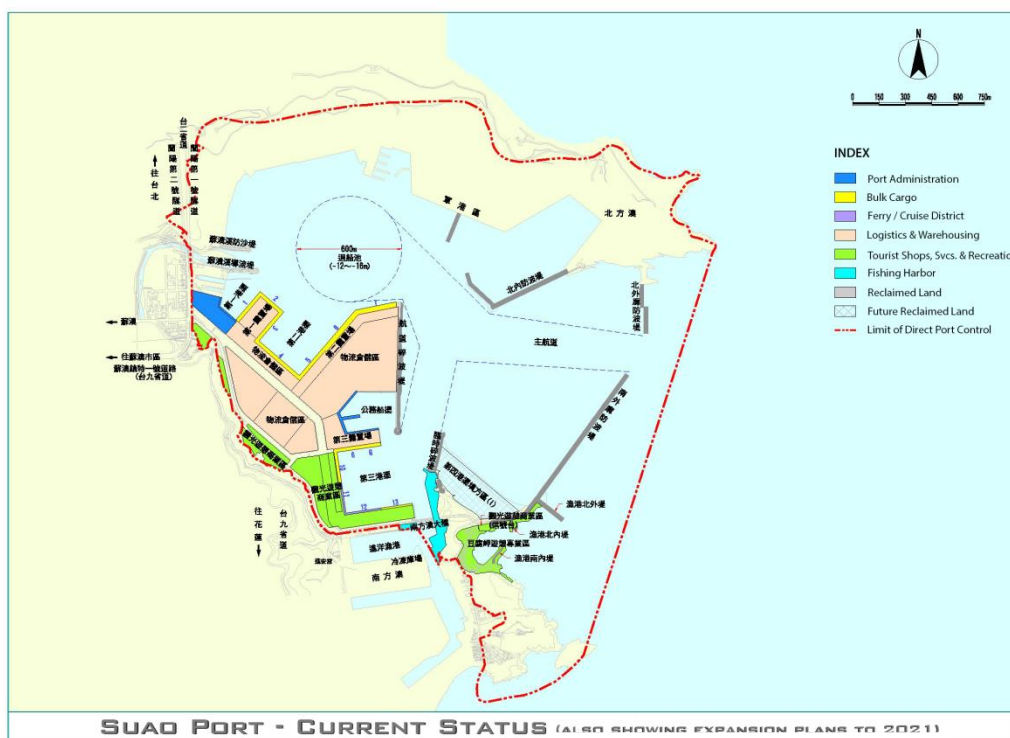

港區示意圖(Port area diagram)

水域經緯度座標及港區界線(WGS84經緯度座標系統)
 Water latitude and longitude coordinates and port boundaries-
 WGS84 latitude/longitude coordinate system

點位 Point	東經 E East Longitude	北緯 N North Latitude
A	121° 53' 08.64"	24° 35' 58.18"
B	121° 52' 42.11"	24° 34' 44.08"

